

Surveyed by: CSL  
 Processed by: NM  
 Checked by: WLH  
 Surveyed: 28th March 2020  
 Issued: 2nd April 2020

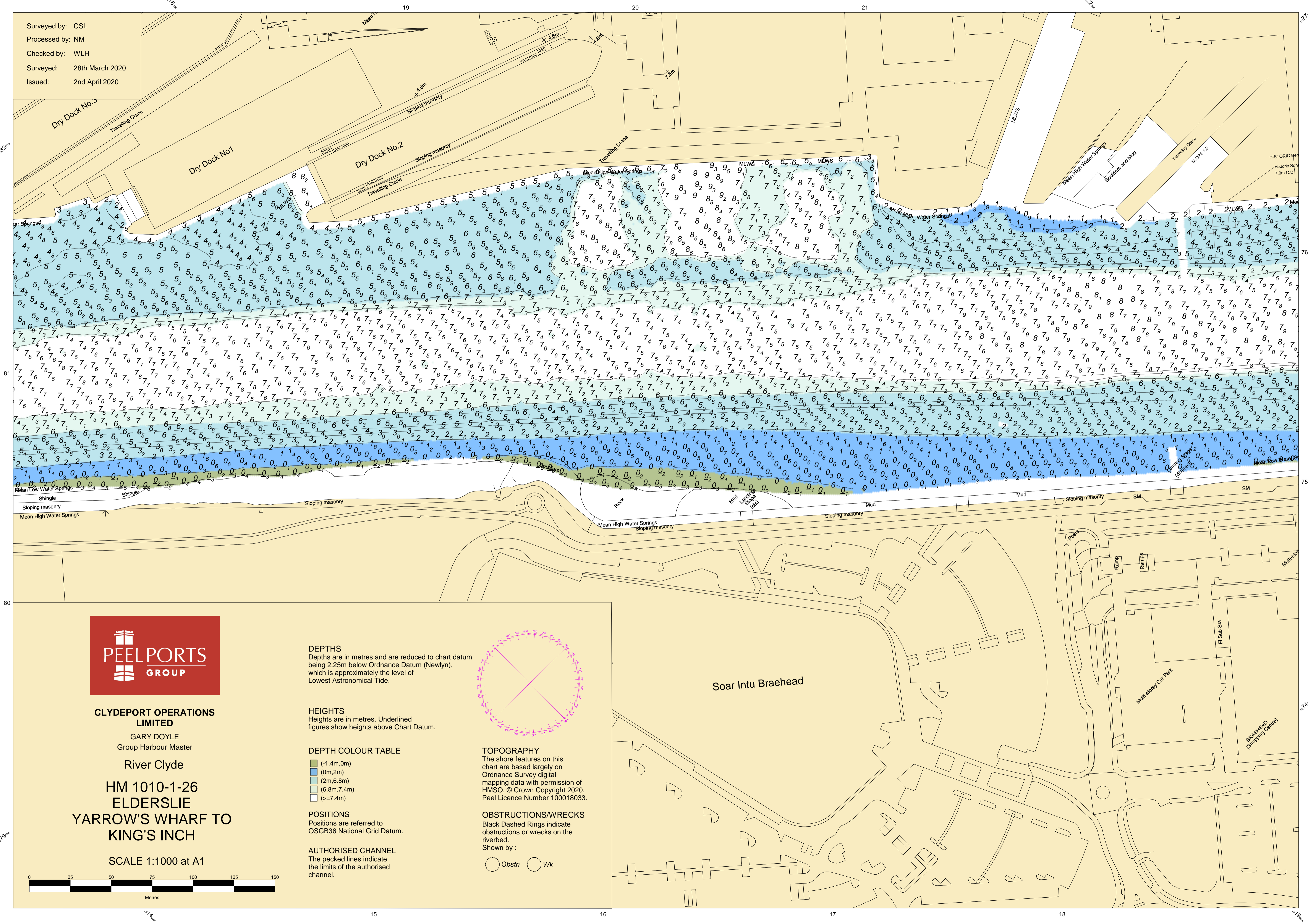

**CLYDEPORT OPERATIONS LIMITED**  
 GARY DOYLE  
 Group Harbour Master  
 River Clyde  
 HM 1010-1-26  
 ELDERSLIE  
 YARROW'S WHARF TO  
 KING'S INCH

SCALE 1:1000 at A1

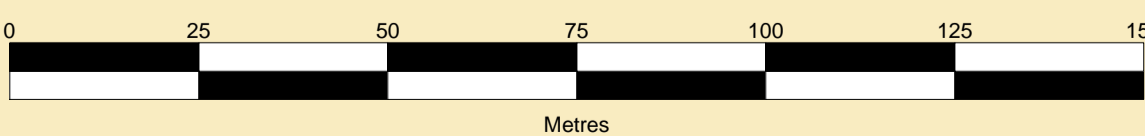

**DEPTHS**  
 Depths are in metres and are reduced to chart datum being 2.25m below Ordnance Datum (Newlyn), which is approximately the level of Lowest Astronomical Tide.

**HEIGHTS**  
 Heights are in metres. Underlined figures show heights above Chart Datum.

**DEPTH COLOUR TABLE**

|            |              |
|------------|--------------|
| Green      | (-1.4m, 0m)  |
| Blue       | (0m, 2m)     |
| Light Blue | (2m, 6.8m)   |
| White      | (6.8m, 7.4m) |
| White      | (>=7.4m)     |

**POSITIONS**  
 Positions are referred to OSGB36 National Grid Datum.

**AUTHORISED CHANNEL**  
 The pecked lines indicate the limits of the authorised channel.

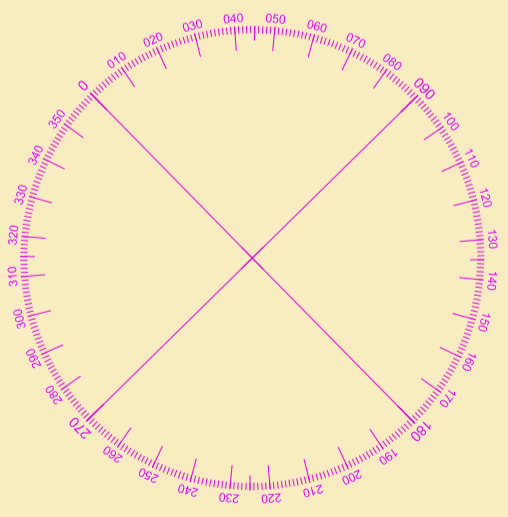

**TOPOGRAPHY**  
 The shore features on this chart are based largely on Ordnance Survey digital mapping data with permission of HMSO. © Crown Copyright 2020. Peel Licence Number 100018033.

**OBSTRUCTIONS/WRECKS**  
 Black Dashed Rings indicate obstructions or wrecks on the riverbed.  
 Shown by:  
 ○ Obstr ○ Wk